

Scale 1" = 40'

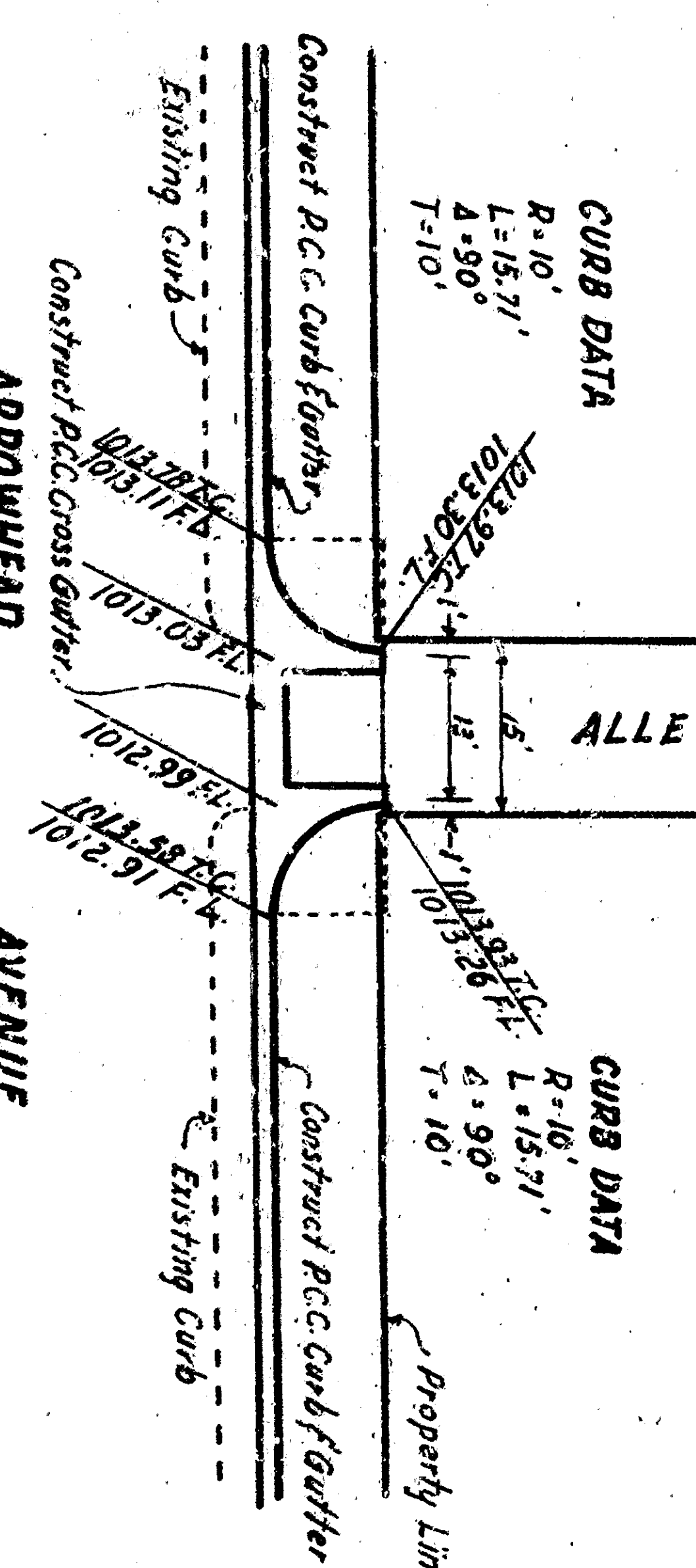


DEPARTMENT OF ENGINEERING
CITY OF SAN BERNARDINO
ARROWHEAD AVENUE
BETWEEN RIALTO AVENUE & SECOND STREET

1. All work shall be in accordance with the Specifications for the Construction of Highways, published by the State of California, Department of Public Works, and the Standard Specifications for Road and Bridge Construction, published by the American Association of Highway Engineers and Road Builders, Inc., 1938 edition, as amended.

2. The Contractor shall be responsible for the accuracy of all data shown on these plans.

3. The Contractor shall be responsible for the accuracy of all field data shown on these plans.

4. The Contractor shall be responsible for the accuracy of all survey data shown on these plans.

5. The Contractor shall be responsible for the accuracy of all utility data shown on these plans.

6. The Contractor shall be responsible for the accuracy of all existing conditions shown on these plans.

7. The Contractor shall be responsible for the accuracy of all proposed conditions shown on these plans.

8. The Contractor shall be responsible for the accuracy of all construction details shown on these plans.

9. The Contractor shall be responsible for the accuracy of all construction methods shown on these plans.

10. The Contractor shall be responsible for the accuracy of all construction materials shown on these plans.

11. The Contractor shall be responsible for the accuracy of all construction equipment shown on these plans.

12. The Contractor shall be responsible for the accuracy of all construction labor shown on these plans.

13. The Contractor shall be responsible for the accuracy of all construction costs shown on these plans.

14. The Contractor shall be responsible for the accuracy of all construction time shown on these plans.

15. The Contractor shall be responsible for the accuracy of all construction quality shown on these plans.

16. The Contractor shall be responsible for the accuracy of all construction safety shown on these plans.

17. The Contractor shall be responsible for the accuracy of all construction environmental shown on these plans.

18. The Contractor shall be responsible for the accuracy of all construction social shown on these plans.

19. The Contractor shall be responsible for the accuracy of all construction economic shown on these plans.

20. The Contractor shall be responsible for the accuracy of all construction cultural shown on these plans.




DEPARTMENT OF ENGINEERING
CITY OF SAN BERNARDINO
ARROWHEAD
BETWEEN RIALTO AVENUE &

1. All work shall be done in accordance with the specifications of the City of San Bernardino and the State of California. The Engineer shall be responsible for the design and construction of the project.

2. The Contractor shall be responsible for obtaining all necessary permits and for the safety of the project.

3. The Contractor shall be responsible for the maintenance of the project during construction.

4. The Contractor shall be responsible for the removal of all construction materials and equipment from the project site.

5. The Contractor shall be responsible for the final inspection and acceptance of the project.

6. The Contractor shall be responsible for the final payment of the project.

7. The Contractor shall be responsible for the final cleanup of the project site.

8. The Contractor shall be responsible for the final record drawing of the project.

9. The Contractor shall be responsible for the final as-built drawing of the project.

10. The Contractor shall be responsible for the final maintenance of the project.